



FEATURES

- Cermet resistive element.
- Available in all series T-21 models (except detent option).
- High power dissipation.
- More than 50.000 operations.
- Series I-21 switches adaptable.

MECHANICAL SPECIFICATIONS

- Mechanical rotation angle: $310^\circ \pm 5^\circ$
- Electrical rotation angle: $290^\circ \pm 20^\circ$
- Operating torque: 0.5 to 1.5 Ncm.
(0.7 to 2.1 in-oz)
- Max. stop torque: > 80 Ncm (> 112 in-oz)

ELECTRICAL SPECIFICATIONS

- Range of values (*)
 $100\Omega \leq R_n \leq 5\text{ M}$ (Decad. 1.0 - 2.0 - 2.2 - 2.5 - 4.7 - 5.0)
- Tolerance (*): $100\Omega \leq R_n \leq 1\text{M}\Omega$ $\pm 20\%$
 $1\text{M}\Omega < R_n \leq 5\text{M}$ $\pm 30\%$
- Max. Voltage: 500 VDC (lin); 250 VDC (no lin)
- Nominal Power 70°C (158°F) (see power rating curve)
2 W (lin); 0.5 W (no lin)
- Taper (**): Lin.; Log.; Alog.
- Residual resistance: $\leq 0.1\% R_n$ (2 Ω min.)
- Equivalent noise resistance: $\leq 3\% R_n$ (3 Ω min.)
- Breakdown voltage: > 750 VAC.
- Operating temperature: -40°C ; $+90^\circ\text{C}$ (-40°F ; 194°F)

(*) Others on request
(**) Other tapers on request. No linear tapers; values higher than 1 K Ω .

HOW TO ORDER

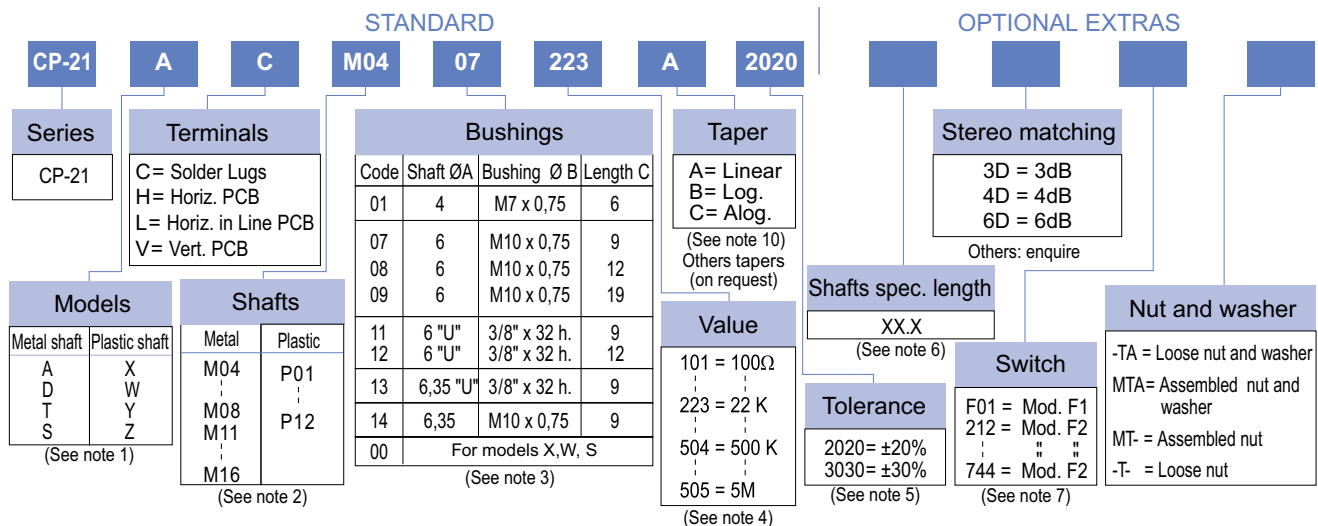

HOW TO ORDER CUSTOM DRAWING

CP-21 A C + DRAWING NUMBER (Max. 16 digits)

This way of ordering should be used for options which are not included in the "How to order" standard and optional extras.

STANDARD OPTIONS

Shaft special length 0; standard length
 Stereo matching Only in model "T" and upon request
 Switch No switch
 Nut & washer Without nut and washer

DIMENSIONS *

CP-21

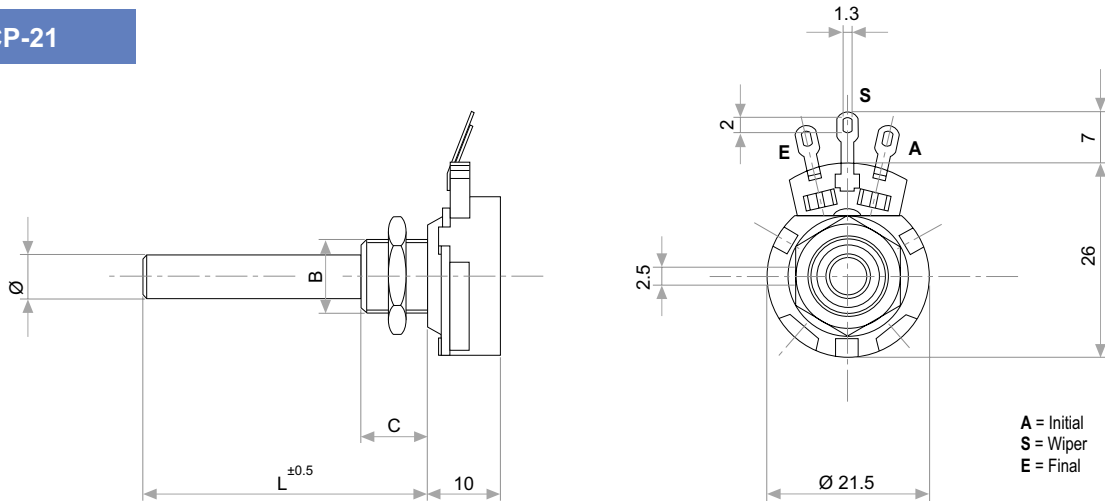

CP-21 with switch

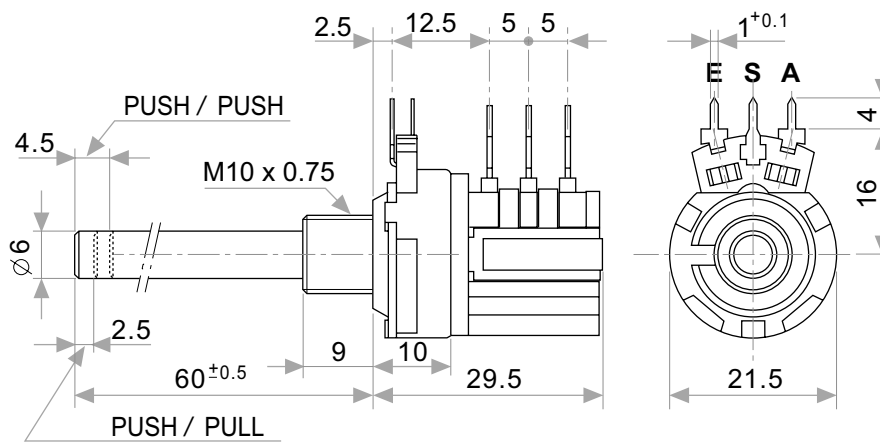

(*) For more detailed information see T-21 data sheet.

TESTS

TYPICAL VARIATIONS

| | | |
|----------------------------------|------------------------------|--------------|
| ELECTRICAL LIFE | 1.000 h. @ 70°C | ± 5 % |
| MECHANICAL LIFE: POT. | 50.000 CYCLES | ± 5 % |
| TCR | -40°C; +90°C (-40°F; +194°F) | ±350 ppm /°C |
| THERMAL CYCLING | 16 h. @ 85°C; 2h. @ -25°C | ± 5 % |
| DAMP HEAT | 500 h. @ 40°C @ 95% HR | ± 5 % |
| VIBRATION (for each plane X,Y,Z) | 2 h. @ 10 Hz ... 55 Hz. | ± 3 % |

NOTE: Out of range values may not comply these results.

PACKAGING

Boxes of 260 x 170 x 110: 150 Singl. Pots.